

Installation Guide (PLT-419C)

PLT

Warning

Caution with main supply and live wires. Install with qualified technician or trained personnel.

Steps for Installation

Step 1

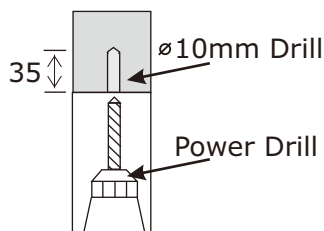

A) Drill Dia. 10mm holes to a depth of 35mm.
(Note: Do not drill too deep)

Step 2

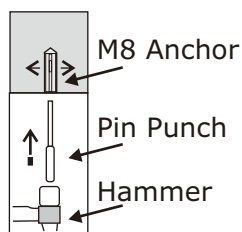

B) Insert M8 anchor into the hole.
C) Use pin punch to expand the anchor.

Step 3

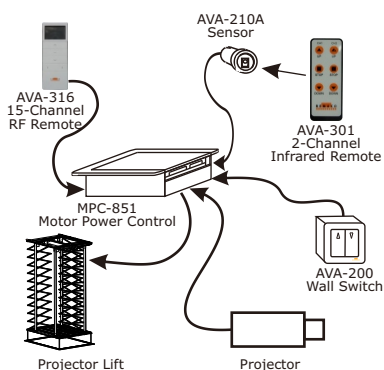

D) Connection of all cables to the MPC-851
(Refer to Installation Guide for MPC-851)

Important Note

All connections are from the MPC.

For connection details, please refer to the Installation Guide provided.

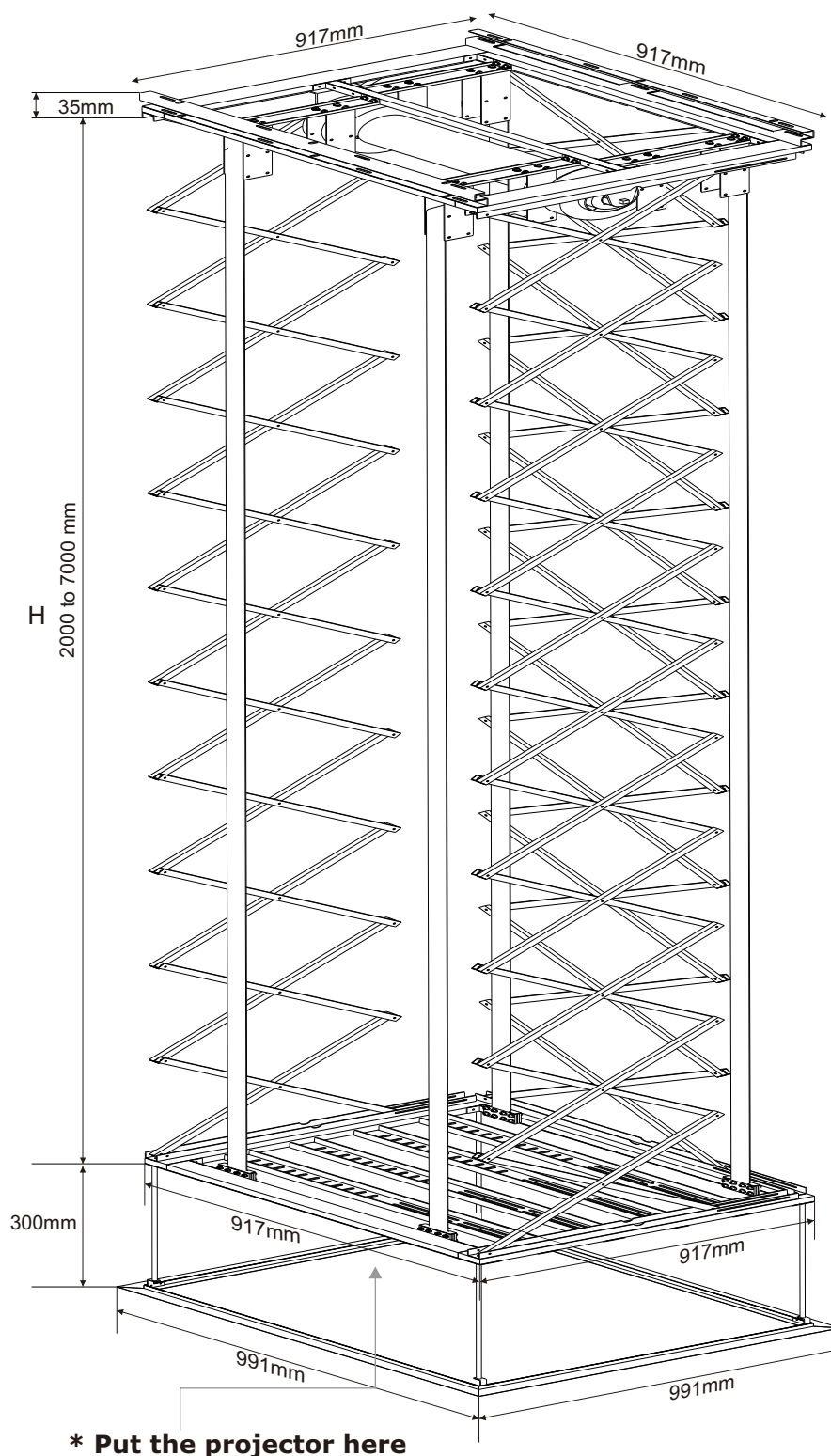

Model	Kept Position Height	Maximum Extended Height
PLT-419C	450mm to 750mm	H = 2000mm to 7000mm
	*Depending on the lift drop height	

Step 4: Pairing, Limit Position, and Deleting

Pairing RF remote to electronic motor

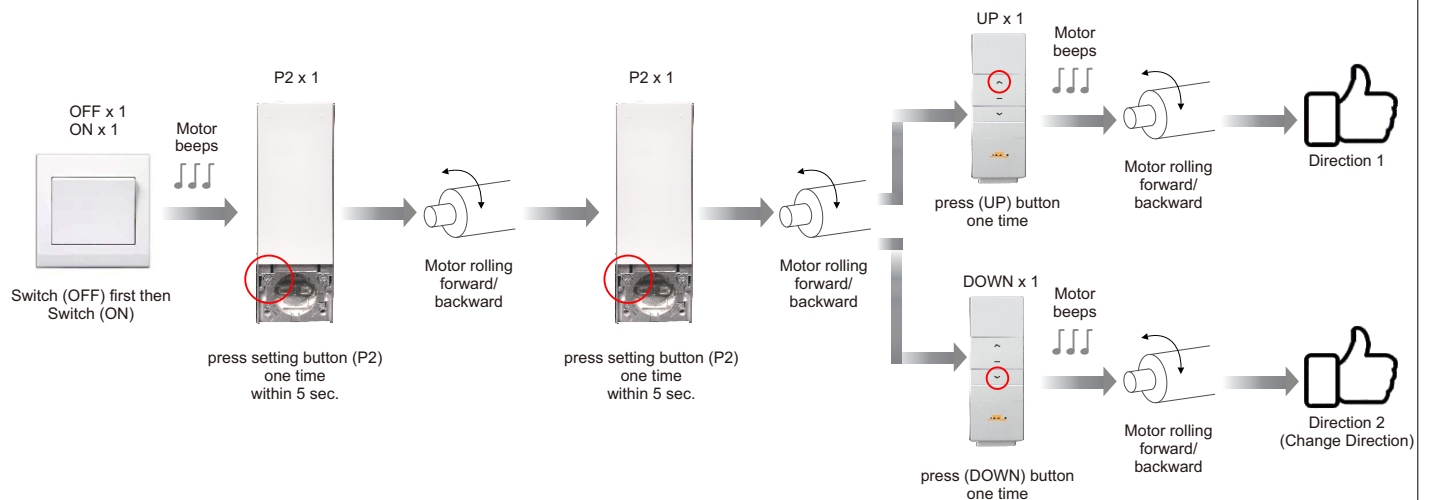

Up and down limit settings

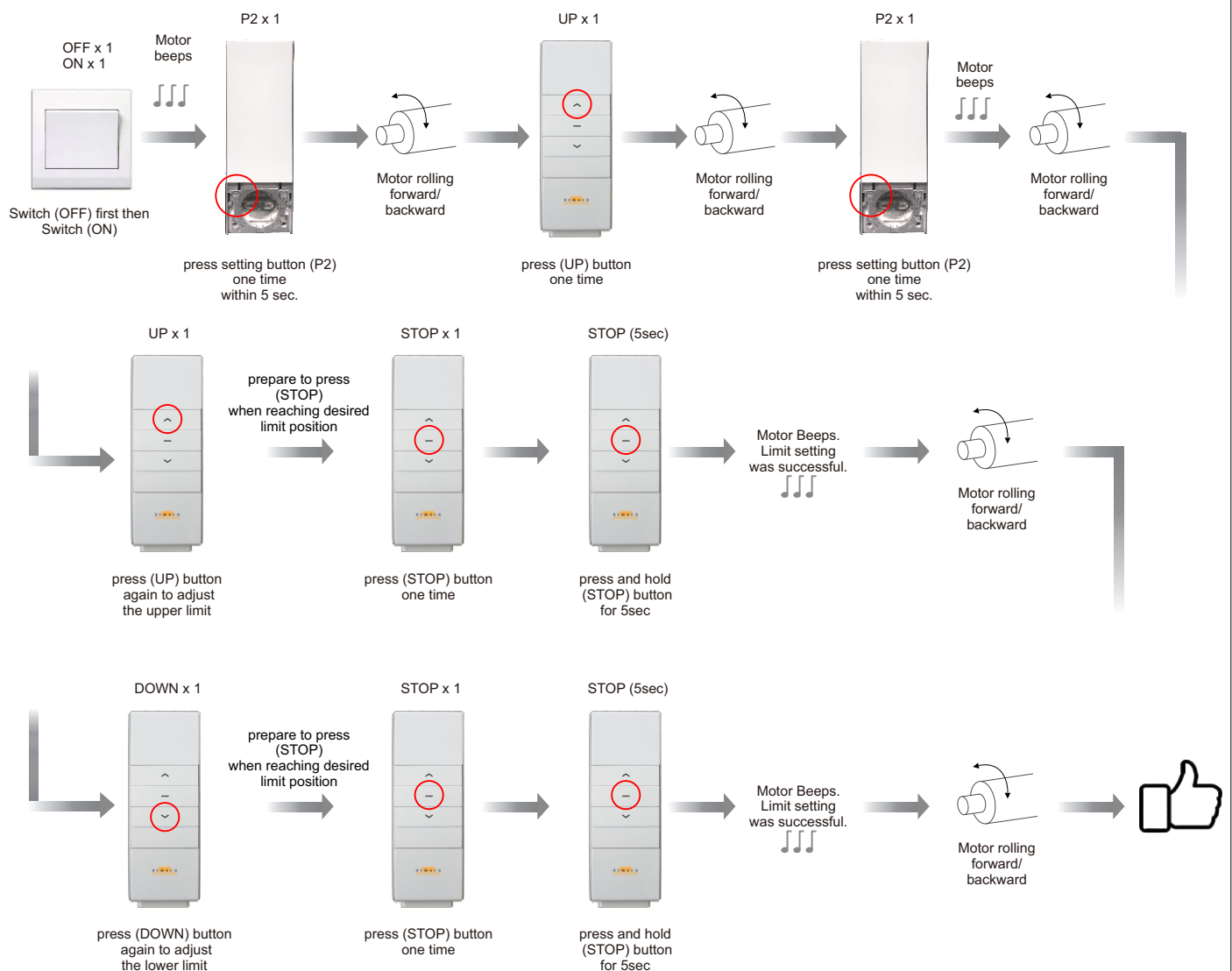

Third limit position (Outside the limit)

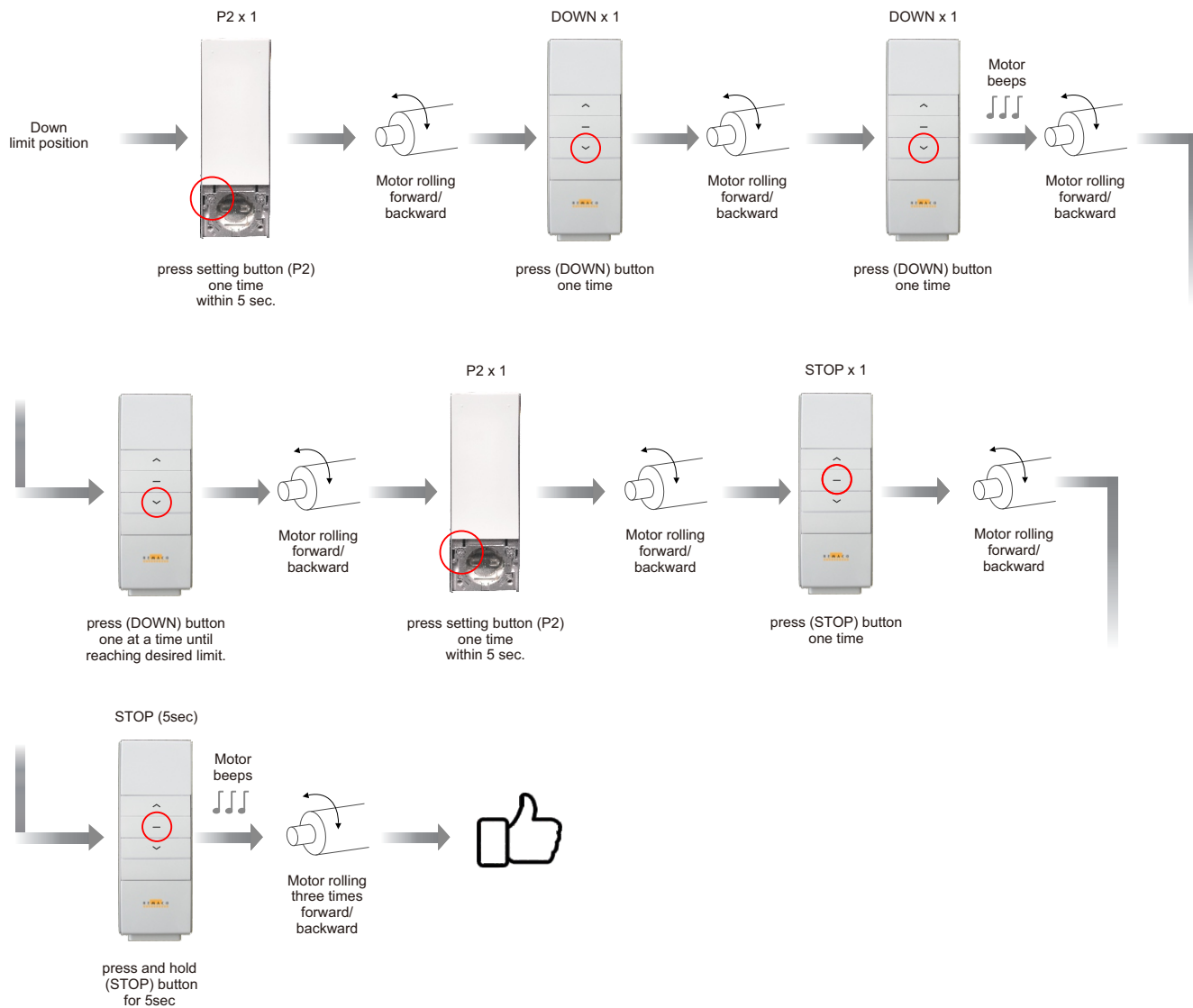

Delete the limit

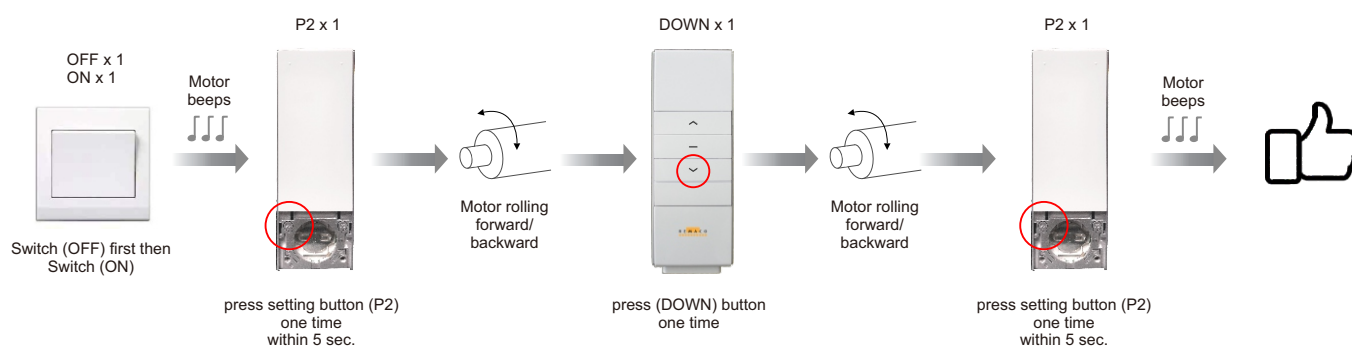

Delete memory of RF remote pairing

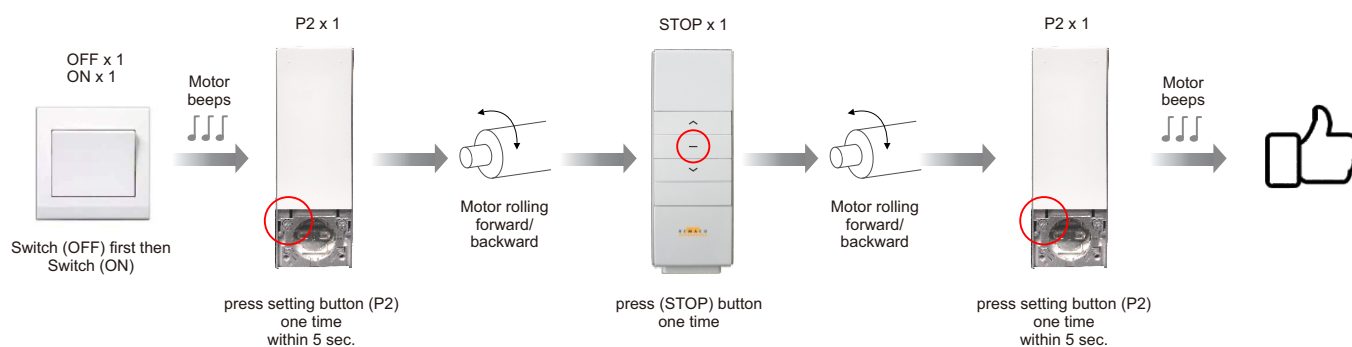

Step 5: False Ceiling Support

Option 1

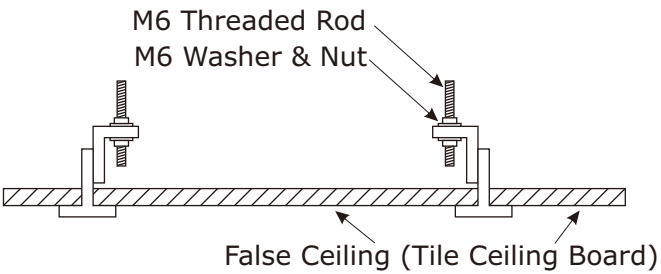

Simple Method to insert false ceiling

Lay false ceiling board 45 degree on false ceiling frame as shown.

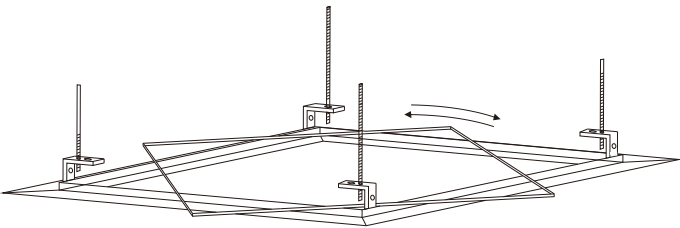

Rotate and false ceiling board will position correctly.

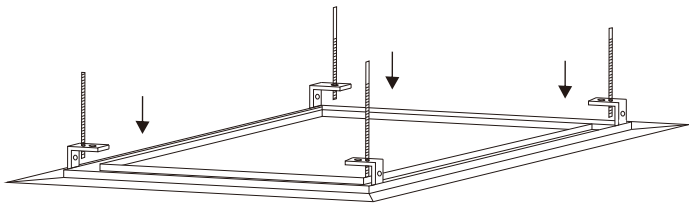

Option 2

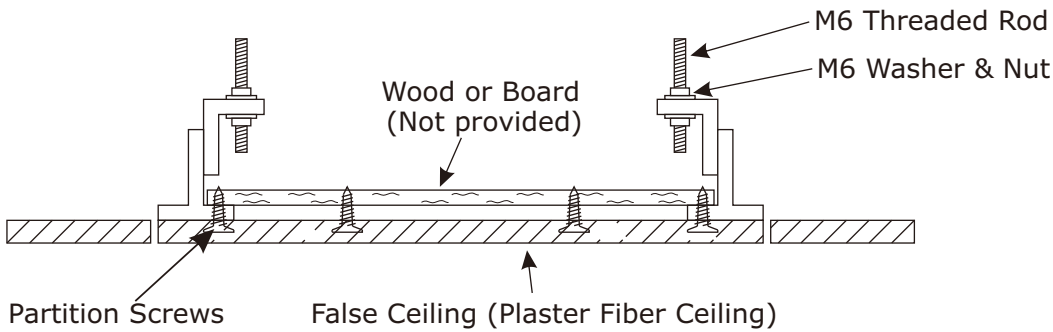

End