

# Installation Guide (PLT-415)

V: 9.0

PLT

## Warning

Caution with main supply and live wires. Install with qualified technician or trained personnel.

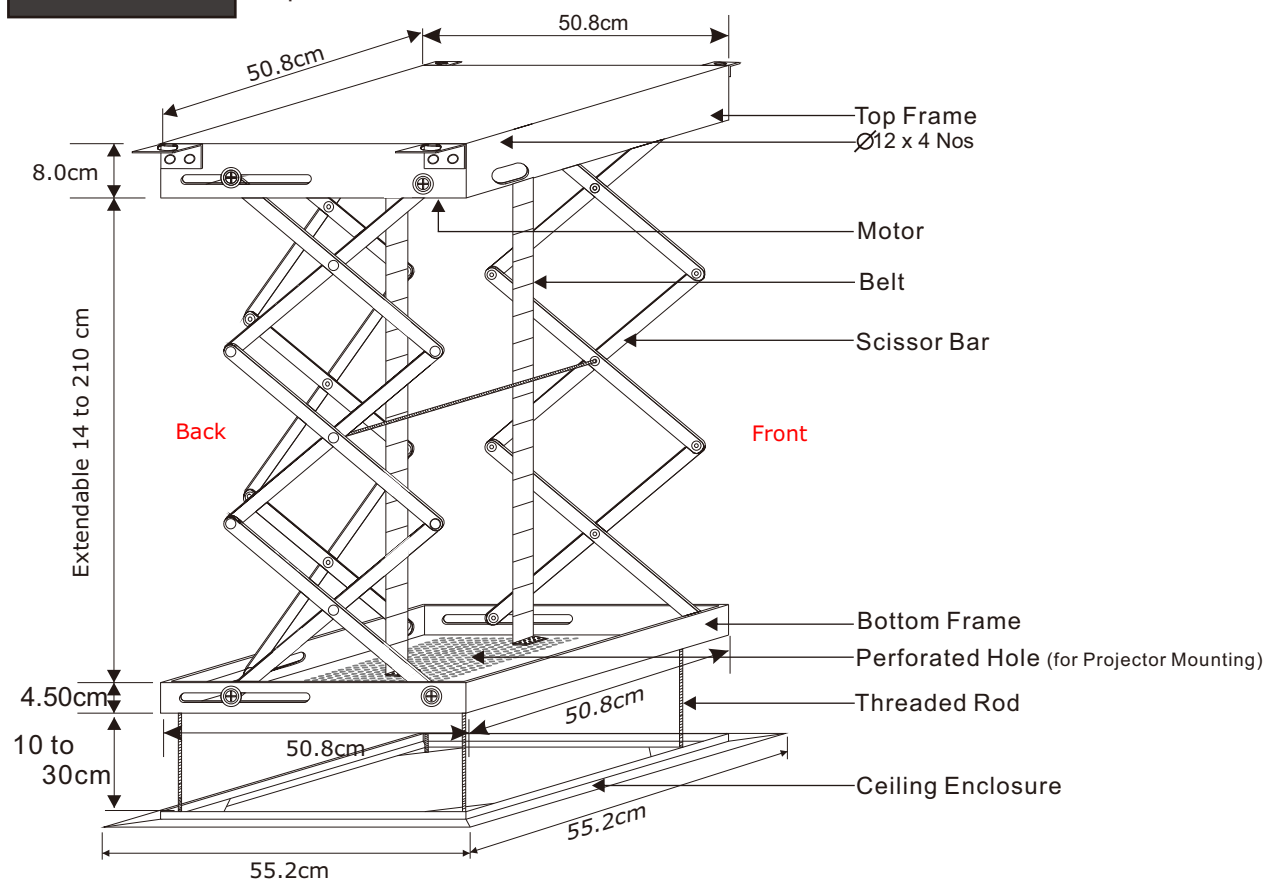

## Types of Installation Mounts

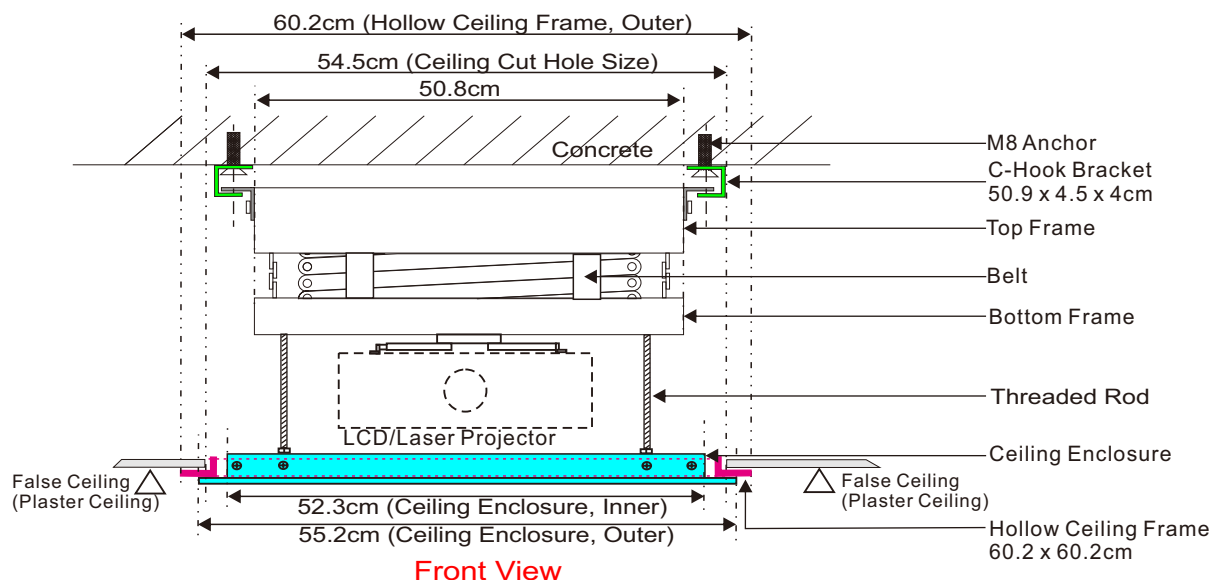
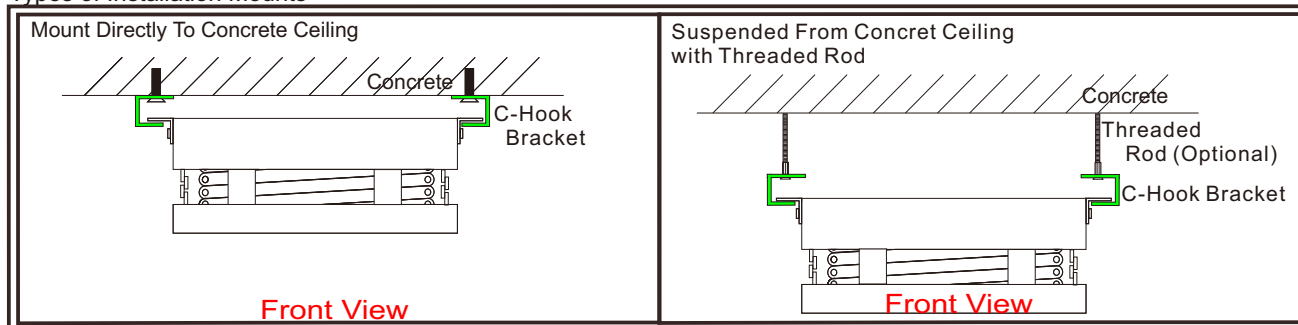

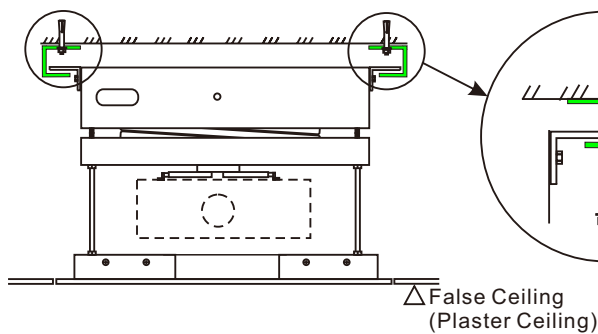
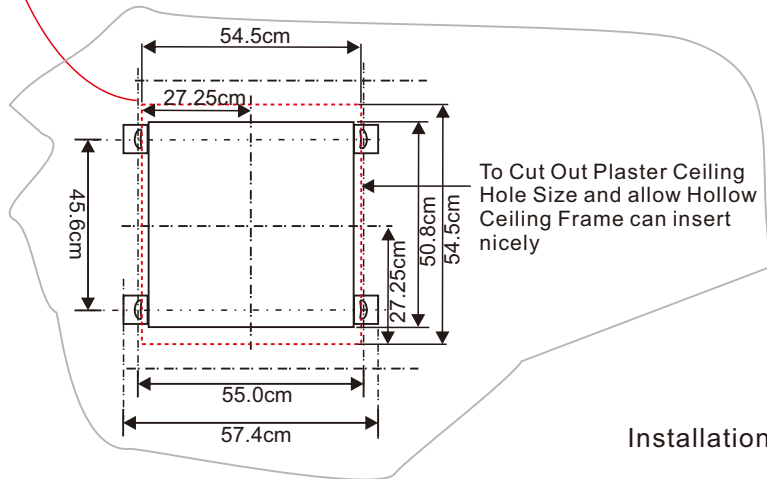
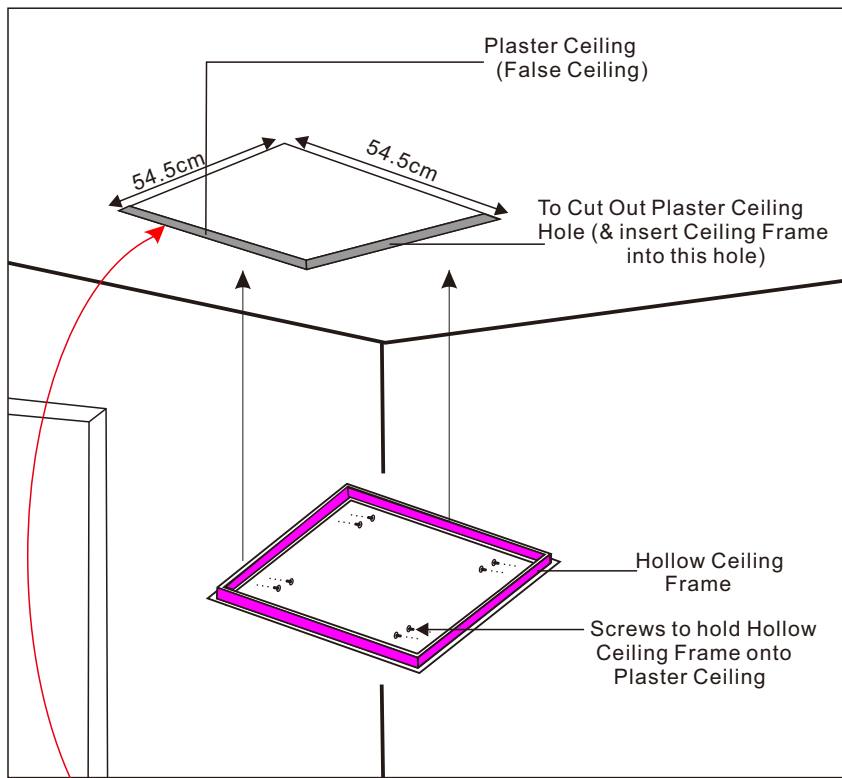

### Step 1

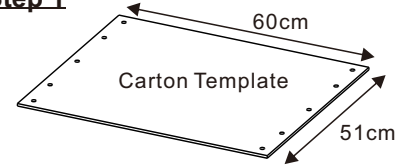

Carton Paper Template for Ease of Marking Hole Position.

### Step 2

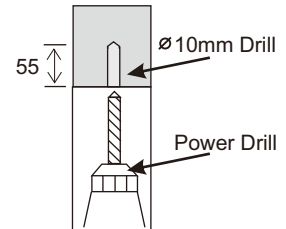

Drill Dia. 10mm holes to a depth of 55mm. (Note: Do not drill too deep)

### Step 3

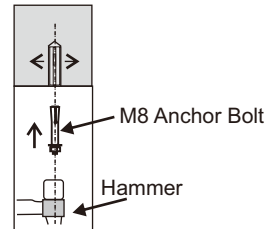

Insert M8 anchor into the hole. Use pin punch to expand the anchor.

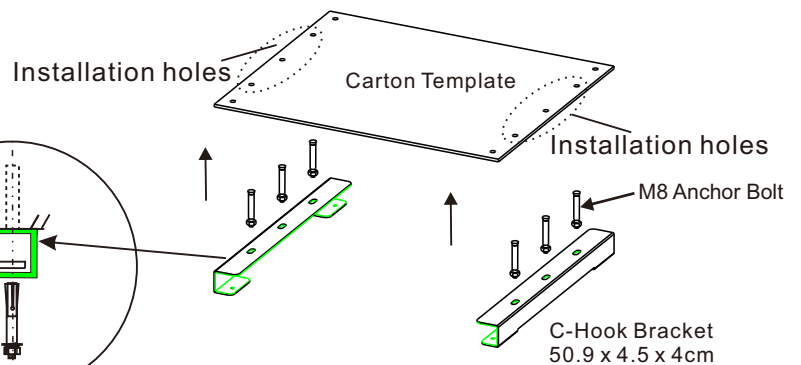

### Step 4

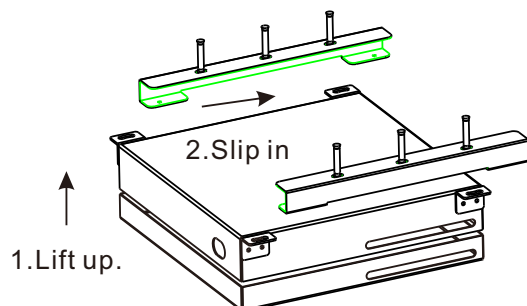

### Step 5

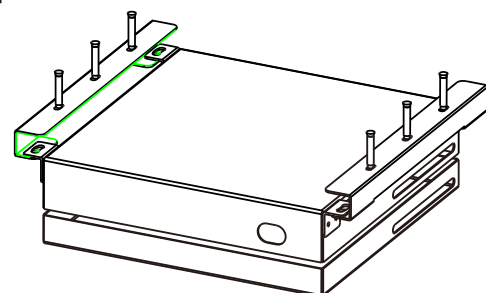

## Step 6

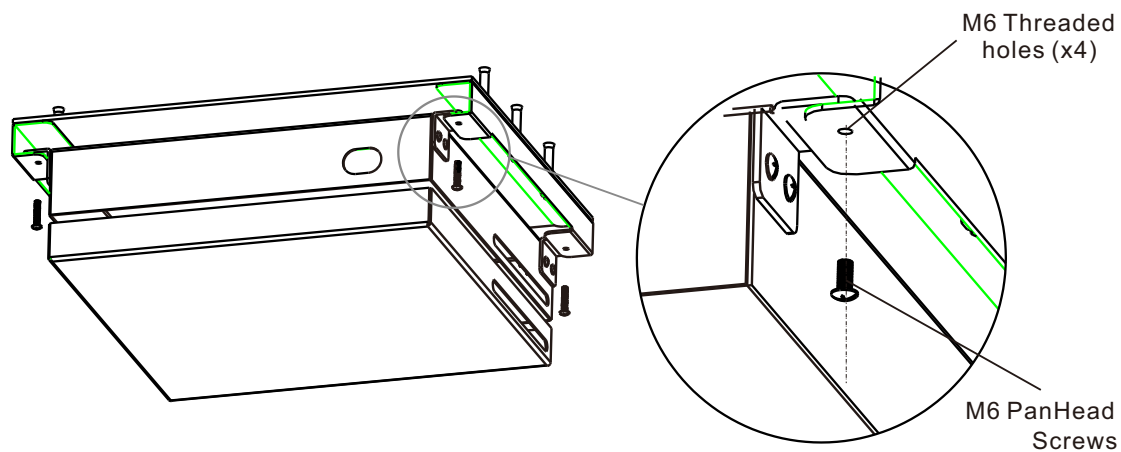

## Step 7

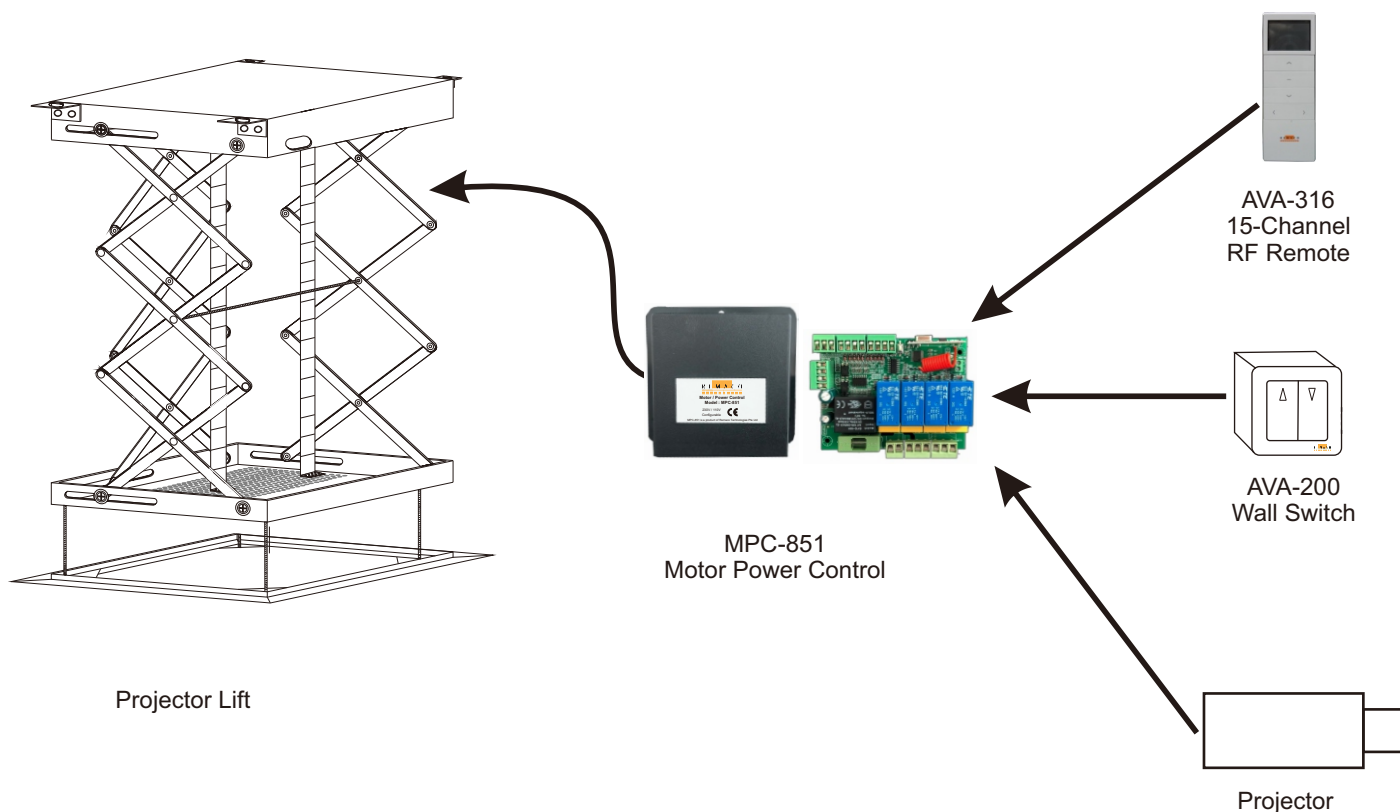

⚠ Connection of all cables to the MPC-851 (Refer to Installation Guide of MPC-851)

## Step 8

### Upper Limit (no need adjust unless required)

" - " move away from top frame  
" + " move closer to top frame

### Lower Limit

" - " less drop (close to top frame)  
" + " more drop (away from top frame)

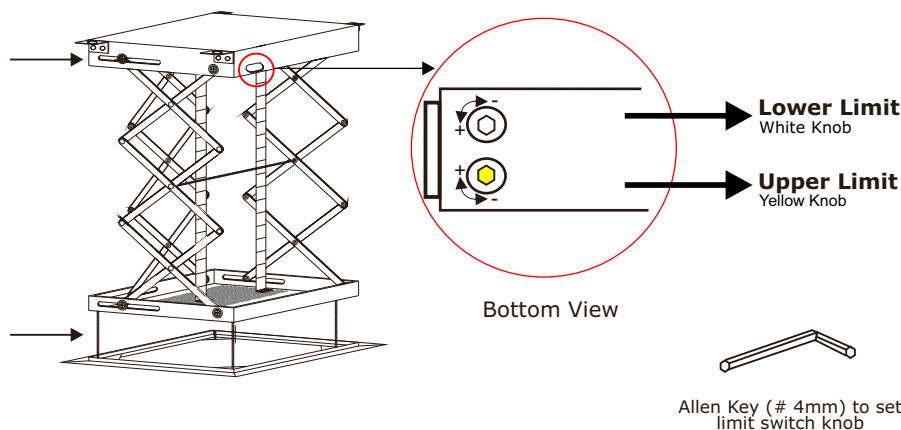

### Important Note

Do not adjust the Upper Limit of the lift higher than the original factory preset position. If adjusted, the lift will move into the frame and be stopped by force and not the Upper Limit Switch. This will cause overheating of the motor, rendering the lift to be unable to operate properly.

### Step 9

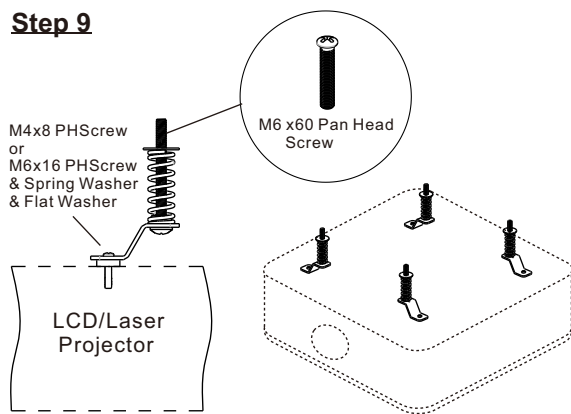

### Step 10

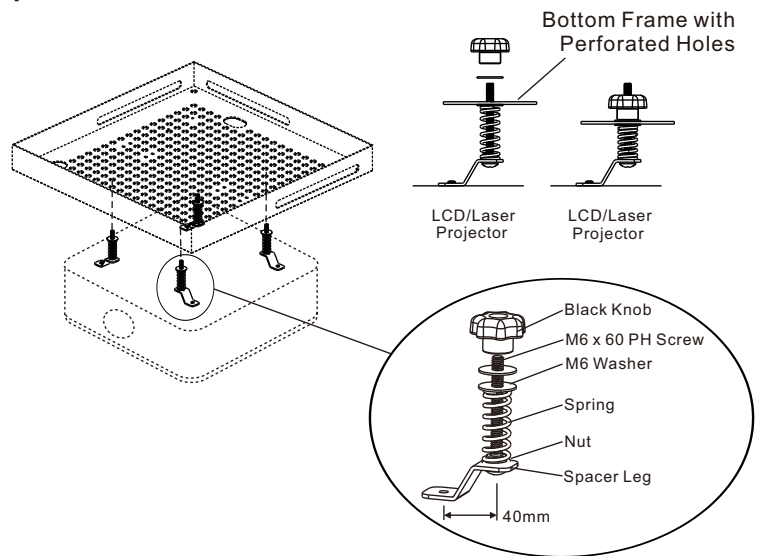

### Step 13

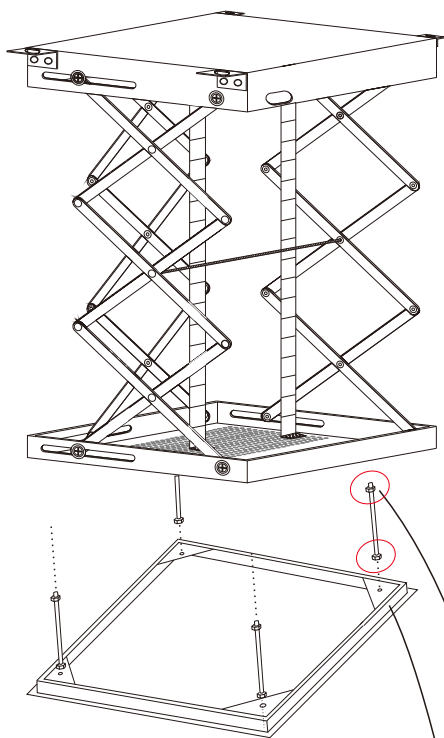

### Step 11

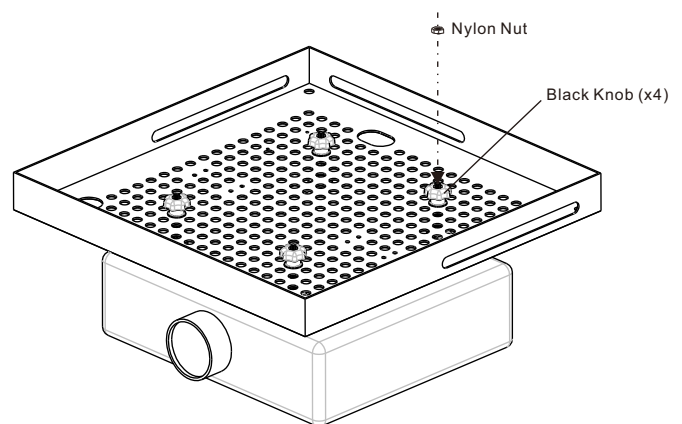

### Step 12

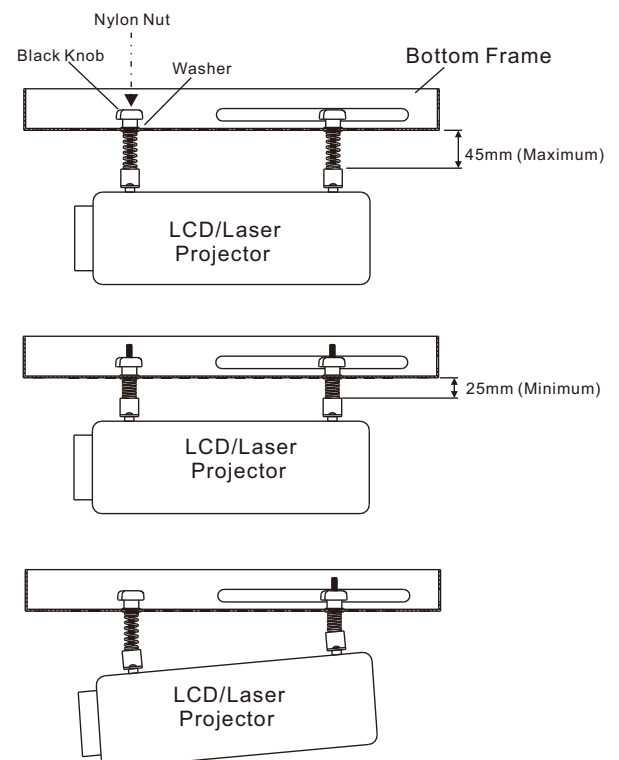

M8  
Threaded  
Rod

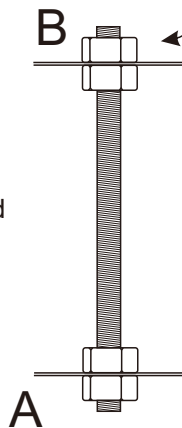

End